

# MULTI-LOAD DRYERS

TRADITIONAL LINE – VEND: 30 LB AND 75 LB



## MICROPROCESSOR CONTROLS

- Easy, programmable controls make setup intuitive
- Owners can control time-of-day pricing and end-user upgrades costs
- End users have option to select ideal cycle for individual drying needs



## RADIAL AIRFLOW SYSTEM

- Provides fast moisture removal to help dry large loads and bulky items
- High BTU burner and airflow



## EZFIT™ DRYER FITS THROUGH A 36” DOOR OPENING

- 35” depth helps with installation
- Allows easy maintenance behind dryer
- 75 lb model only



## BUILT TO LAST

- Large-Capacity Lint Compartment - helps dry clothes evenly by allowing more airflow to pass through
- Heavy-Duty Motor - handles large loads with ease
- Extra-Large Door Opening - provides unhindered access while loading and unloading clothes
- Extra-Large Security Coin Vault – helps keep coins safe



**COIN EQUIPPED**  
MDG76PCCWW pictured  
(Also available in Stainless)

**COIN EQUIPPED**  
MDG30PCDWW pictured

MULTI-LOAD DRYERS – TRADITIONAL LINE		
CAPACITY	MODEL NUMBER	COLOR
30 lb	MDG30PCDWW	White
75 lb	MDG76PCCWW	White
75 lb	MDG76PCCWS	Stainless



**AMERICA**  
AN AMERICAN COMPANY FOR OVER 100 YEARS

See [maytagcommerciallaundry.com](http://maytagcommerciallaundry.com) for warranty details.

VISIT [MAYTAGCOMMERCIALLAUNDRY.COM](http://MAYTAGCOMMERCIALLAUNDRY.COM) FOR MORE INFORMATION.

®/™ © 2020 Maytag. All rights reserved.  
MY200036 9/20

# MULTI-LOAD DRYERS

TRADITIONAL LINE – VEND: 30 LB AND 75 LB



## GAS MULTI-LOAD DRYERS 120V/60 HZ/1 PHASE

FRONT VIEW

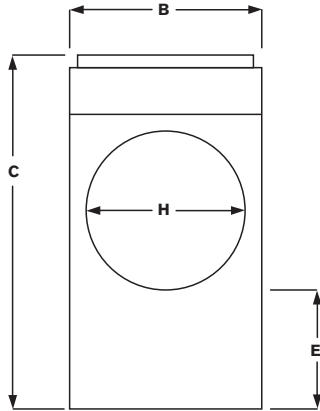

TOP VIEW

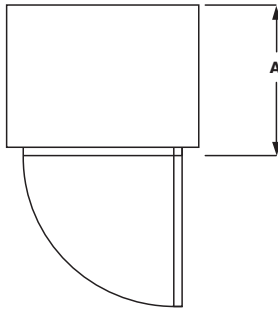

BACK VIEW

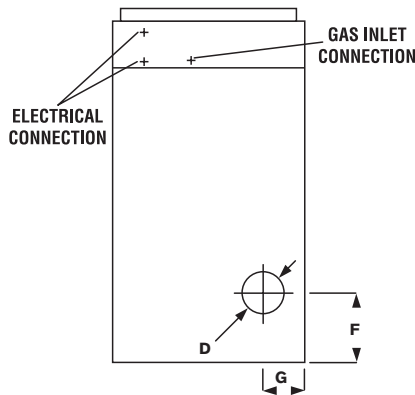

MODELS	MDG30 (PC)	MDG76 (PC)
<b>CAPACITY</b>		
Number of Dryer Pockets	1	1
Cylinder Volume Each Pocket — cu. ft. (liters)	12.27 (347)	22.40 (634)
Cylinder Diameter Each Pocket — in. (mm)	30 (762)	44.5 (1,130)
Cylinder Depth Each Pocket — in. (mm)	30 (762)	24.88 (632)
Dry Load Capacity Each Pocket — lb (kg)	30 (13.60)	75 (34)
<b>GAS SPECS/AIRFLOW</b>		
Drive Motor Size — hp (kW)	½ (.37)	1 (.75)
Blower Motor Size — hp (kW)	-	-
Airflow Type	Radial	Radial
Airflow — cfm (cmm)	600 (17)	1,200 (34)
Gas Inlet Size — in.	.50 M.N.P.T.	.75 F.N.P.T.
Heat Input, Gas — btu/hr (kcal/hr)	90,000 (22,680)	204,000 (51,407)
Number of Exhausts	1	1
(D) Exhaust Duct Diameter — in. (mm)	8 (203)	10 (254)
<b>ELECTRICAL REQUIREMENTS</b>		
Breaker Fuse — Amps	15	20
<b>DIMENSIONS</b>		
(A) Depth — in. (mm)	43 (1,092) (1,027)	35 (889)
(B) Width — in. (mm)	31.38 (797)	46.18 (1,173)
EzFit™ Dryer — Fits Through 36" Door Opening	Yes	Yes
(C) Height — in. (mm)	72 (1,829)	84.31 (2,142)
(H) Door Opening — in. (mm)	21.50 (546)	31.38 (797)
(E) Height to Bottom of Door — in. (mm)	32 (813)	31 (787)
(F) Height to Center of Exhaust — in. (mm)	20-1/4 (514)	16-3/4 (425)
(G) Width to Center of Exhaust — in. (mm)	6-1/4 (159)	10 (254)
<b>APPROXIMATE WEIGHT</b>		
Uncrated — lb (kg)	535 (243)	888 (403)
Crated — lb (kg)	585 (265)	938 (425)
<b>CONTROL/USER INTERFACE</b>		
Control Type	Microprocessor	Microprocessor
Display Type	Digital	Digital
Vended Controller	Yes	Yes
OPL Controller	No	No
<b>CONSTRUCTION</b>		
Cylinder	Galvanized Steel	Galvanized Steel
Top	Painted CRS	Painted CRS
Front	White	White/Stainless Steel
Sides	Painted CRS	Painted CRS



Dimensions are for planning purposes only. See specific instructions for proper installation. Because of continuous product improvement, Maytag reserves the right to change specifications without notice.